

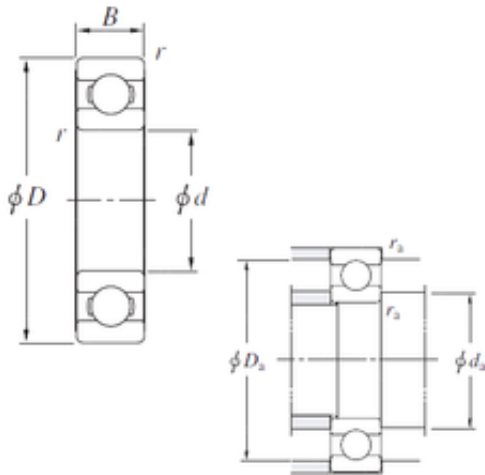

Bearing Import and Export Co., Ltd.



6876 Bearing 2D drawings and 3D CAD models

380 mm x 480 mm x 46 mm KOYO 6876 Single-row deep groove ball bearings

Bearing No. 6876

Size	380x480x46 mm
Bore Diameter	380 mm
Outer Diameter	480 mm
Width	46 mm
d	380 mm
D	480 mm
B	46 mm
C	46 mm
r min.	2,1 mm
da min.	391 mm
Da max.	469 mm
ra max.	2 mm
Weight	20 Kg
Basic dynamic load rating (C)	244 kN
Basic static load rating (C0)	359 kN
(Grease) Lubrication Speed	980 r/min
(Oil) Lubrication Speed	1200 r/min
Bearing No.	6876
r(min)	2.1
Cr	305
C0r	359
Cu	8.95
f0	16.2
Grease lub.	980
Oil lub.	1200



Bearing Import and Export Co., Ltd.

da(min)	391
Da(max)	469
ra(max)	2
(Refer.)Mass(kg)	20.0